

in[mm]

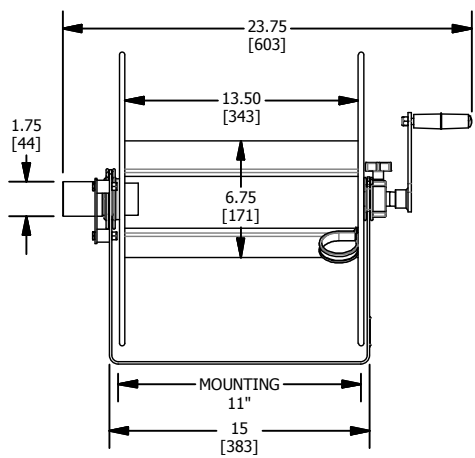

V-117

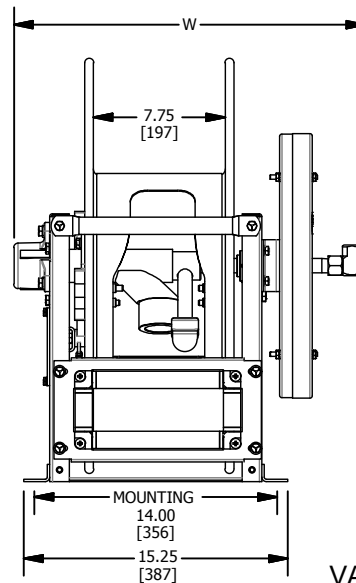
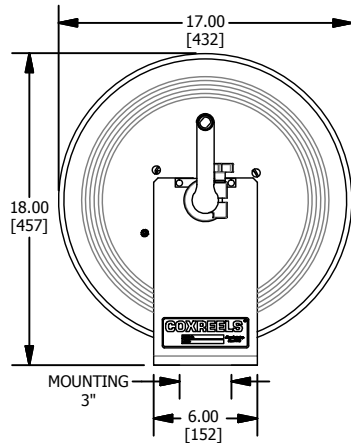

VA-DLPL

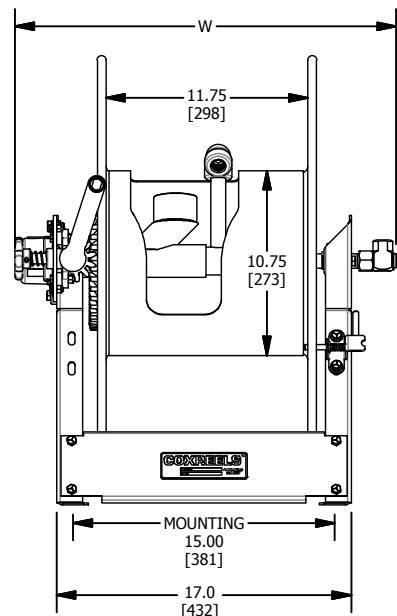
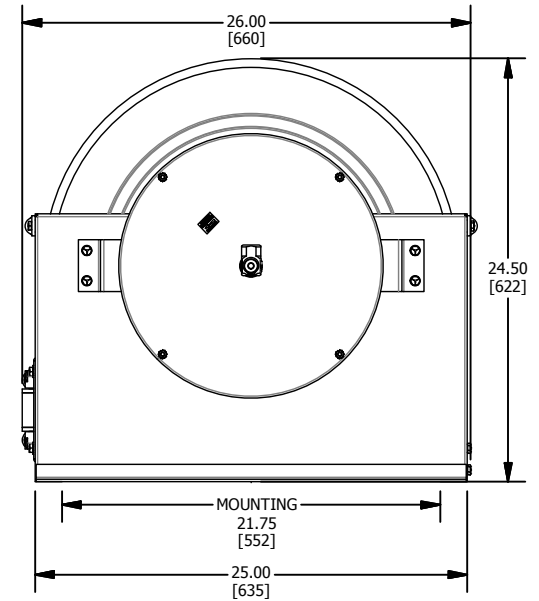

VA-1175

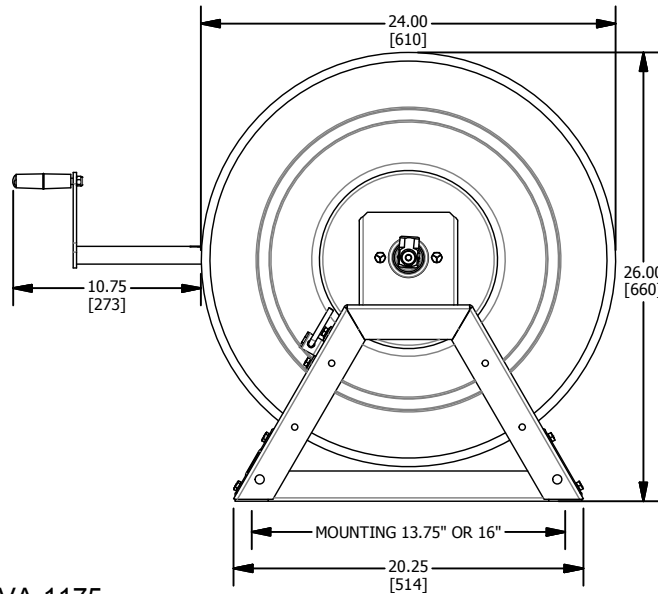

**PART NUMBER**

V  - XXXX - XXX - X

WITH AIR- ADD "A"

BASE MODEL:  
117  
1175  
SLPL  
DLPL

CAPACITY (FT)  
CRANK  
-C FRONT  
-T TOP

HOSE SIZE  
-8 (1-1/2" NPT)

SPECIFICATIONS		
FEATURE	SPEC.	OPTION
PRESSURE /VAC	300 Psi / 29" Hg	CONTACT COX REPS
MOUNTING	FLOOR	WALL, OVERHEAD
VACUUM	1 3/4" NPT	-
AIR	1/2" NPT	-

MATERIAL SPECIFICATIONS		
COMPONENT	MATERIAL	OPTIONS
PLUMBING	STEEL	-
REEL	STEEL	-
BEARINGS	BRONZE, SELF LUBE	-
FINISH	BLUE POLYESTER POWDER COAT (B)	RED(R), GREEN(N), WHITE(W), BLACK [WRINKLE(C)/GLOSS(K)], GREY(G)

MODEL	dW in[mm]	W in [mm]	X in [mm]	CAPACITY ft[m]	WEIGHT lbs[Kg]
V-117-850	6.75 [295]	23.62 [600]	15 [381]	50 [15]	28 [13]
V-1175-850	11.62 [295]	24.9 [632]	17.1 [434]	50 [15]	118 [53]
V-1175-850-C	11.62 [295]	22 [559]	17.1 [434]	50[15]	121 [55]
V-1175-850-T	11.62 [295]	22 [559]	17.1 [434]	50 [15]	121 [55]
V-1175-850*	11.62 [295]	21.75 [552]	17.1 [434]	50 [15]	123 [56]
VA-1175-850-C*	11.62 [295]	21.75 [552]	17.1 [434]	50 [15]	126 [58]
VA-1175-850-T*	11.62 [295]	27.75 [705]	17.1 [434]	50 [15]	126 [58]
V-SLPL-825	7.5 [190]	17.5 [444]	15.4 [391]	25 [7]	102 [46]
V-DLPL-825	7.5 [190]	20.12 [511]	15.4 [391]	25 [7]	107 [48]

**UNLISTED OPTIONS & CUSTOM REELS**

NOT ALL OPTIONS ARE LISTED. CONTACT YOUR SALES REPRESENTATIVE OR FACTORY FOR ADDITIONAL OPTIONS & CUSTOM MODIFICATIONS

**COXREELS**

5865 S Ash Avenue Tempe, Az 85283  
1-800-COX-REEL www.coxreels.com

THIS DOCUMENT CONTAINS PROPRIETARY INFORMATION AND IS THE PROPERTY OF COXREELS, INC. THE COPYING, DISTRIBUTION AND UTILIZATION OF THIS DOCUMENT AS WELL AS COMMUNICATION OF ITS CONTENT TO OTHERS WITHOUT THE WRITTEN AUTHORIZATION OF COXREELS, INC., IS PROHIBITED.

TITLE: **V SERIES**

DWG. NO.: **V SERIES**

REV. -

3RD ANGLE

INTERPERT PER ASME : Y14.5M-1994 DO NOT SCALE DWG.

SIZE: **A**

SHT: 1 OF: 1